

**BROYEUR PRO**  
1720 07.16

# SFA



**SANIBROYEUR® Pro** <sup>UP</sup>









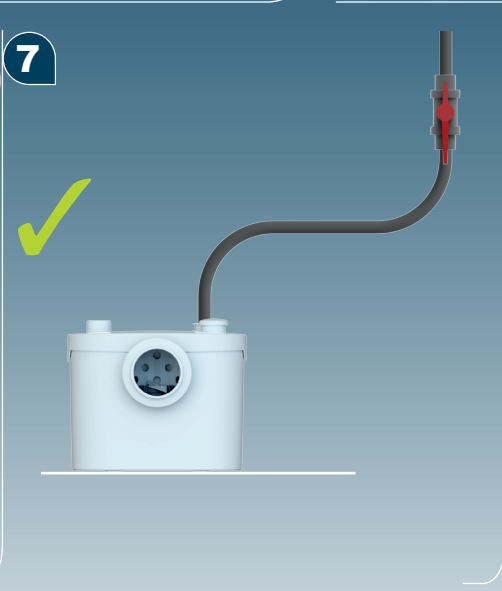
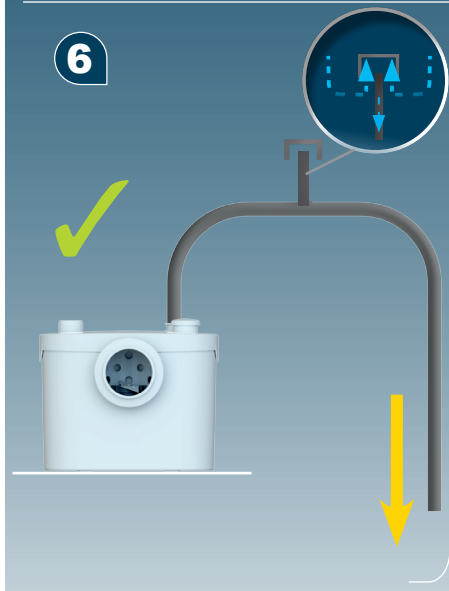
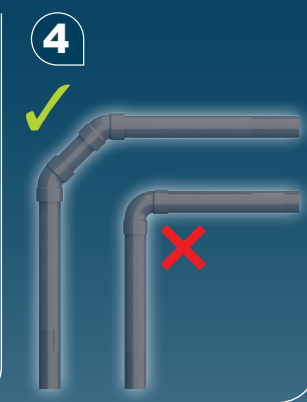
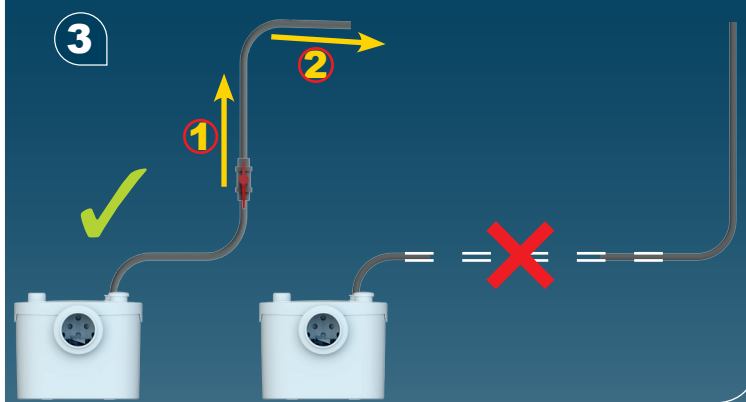
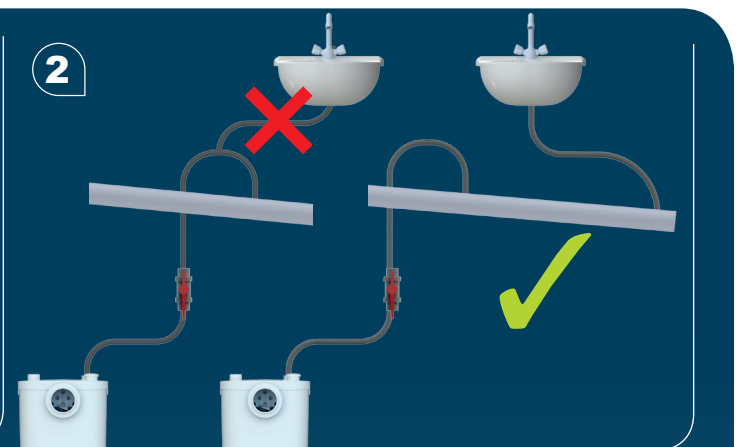
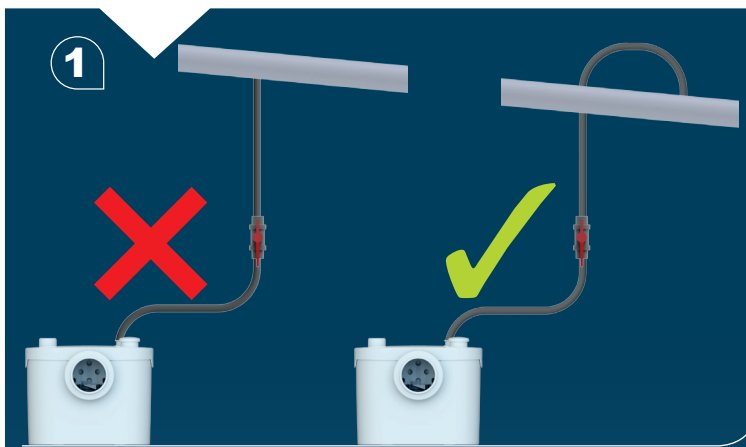
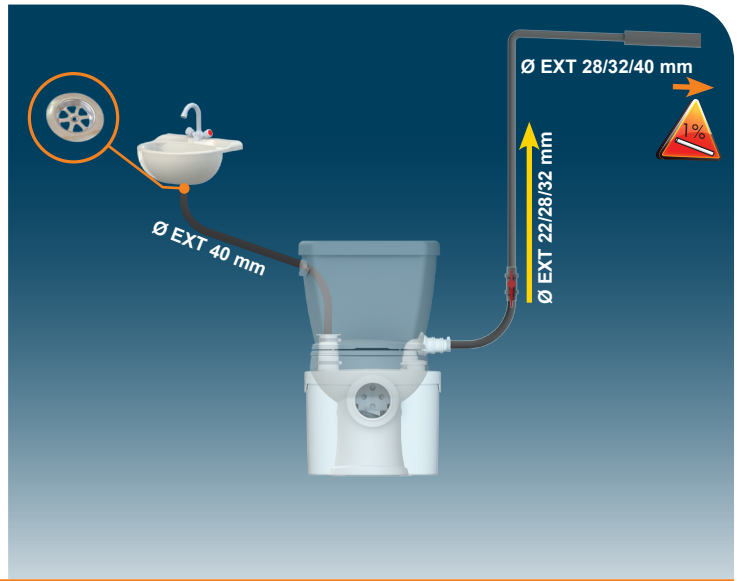
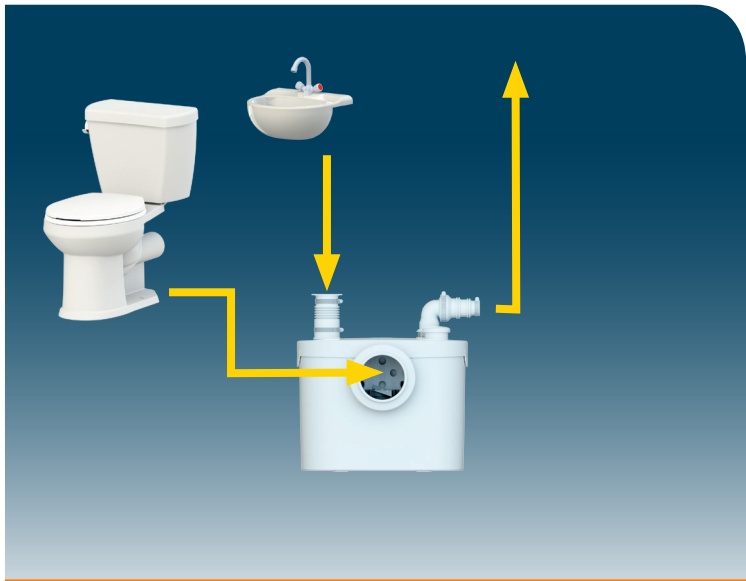

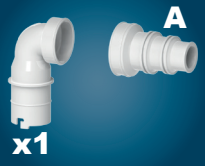

**SANIBROY® Pro** <sup>UP</sup>

**SANITOP®** <sup>UP</sup>





- |  |  |   |
|--|--|---|
| <b>FR</b> NOTICE D'INSTALLATION          | <b>SE</b> INSTALLATIONSANVISNING               | <b>RO</b> MANUAL DE INSTALARE           |
| <b>UK</b> INSTALLATION INSTRUCTIONS      | <b>DK</b> INSTALLATIONSVEJLEDNING              | <b>CZ</b> NÁVOD K INSTALACI A POUŽÍVÁNÍ |
| <b>DE</b> INSTALLATIONSHINWEISE          | <b>NO</b> INSTALLASJONSANVISING                | <b>TR</b> KURULUM KILAVUZU              |
| <b>IT</b> ISTRUZIONI PER L'INSTALLAZIONE | <b>FI</b> ASENNUSOHJEET                        | <b>CN</b> 用户应保留安装指南以备                   |
| <b>ES</b> MANUAL DE INSTALACIÓN          | <b>HU</b> FELSZERELÉSI ÉS KEZELÉSI ÚTMUTATÓ    | <b>KR</b> 설치내용서                         |
| <b>BR</b> <b>PT</b> MANUAL DE INSTALAÇÃO | <b>PL</b> INSTRUKCJA INSTALACJI                | <b>HR</b> UPUTA ZA INSTALACIJU          |
| <b>NL</b> INSTALLATIE VOORSCHRIFTEN      | <b>RU</b> ИНСТРУКЦИЯ ПО МОНТАЖУ И ЭКСПЛУАТАЦИИ | <b>AR</b> بيكرتلا قرط                   |

CE



 <b>x1</b>	 <b>x4</b> 32x55	 <b>x1</b> 25x40	 <b>x1</b> 20x32	 <b>x1</b> Ø EXT 40mm	 <b>x4</b>
 <b>x2</b>	 <b>x2</b>	 <b>x1</b>	 <b>x1</b>	 <b>x1</b>	 <b>x1</b>

 **ONLY**

 <b>x1</b>	 <b>x3</b> 32x55	 <b>x0</b> 25x40	 <b>x2</b> 20x32
--	--	--	---



**1**

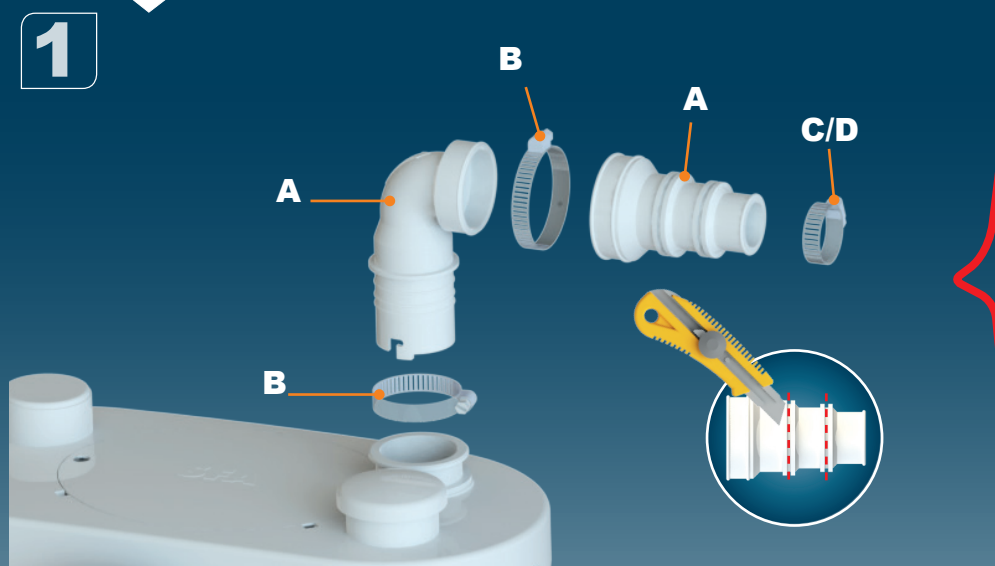

**Ø EXT 22 mm**

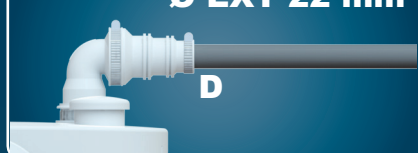

**Ø EXT 28 mm**



**Ø EXT 32 mm**



**2**

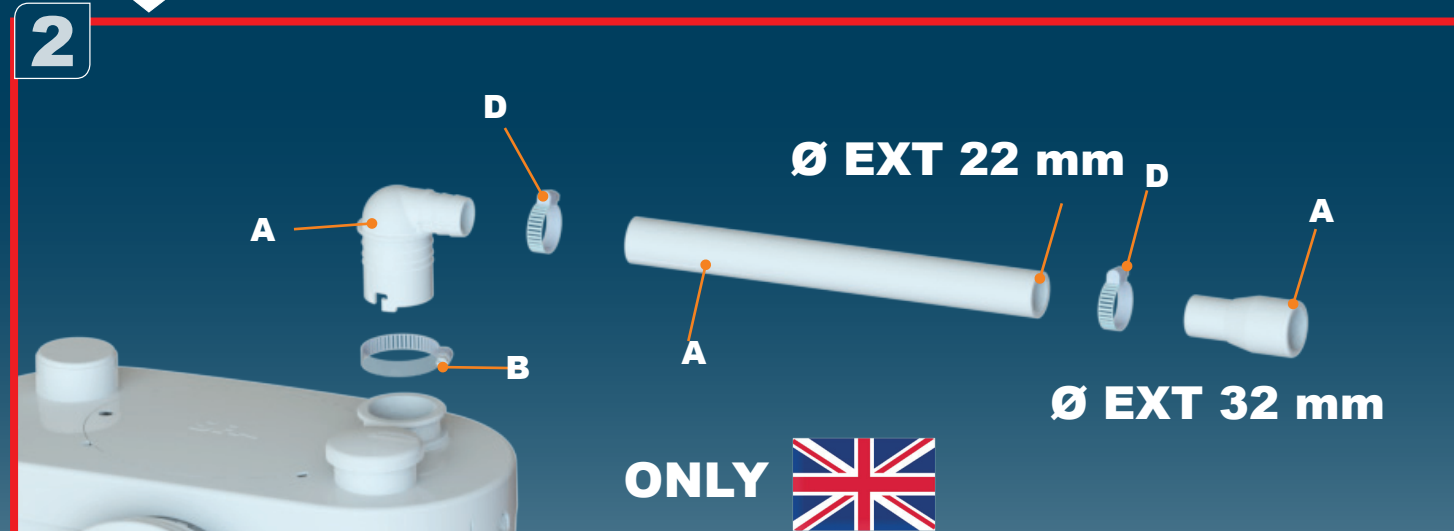

**ONLY** 