

## Wilo-Opti-Box KH

Mini Sewage Lifting plant

### Identification Code

<b>e.g.:</b>	<b>Wilo- KH 32 - 0,4</b>
<b>KH</b>	Mini sewage lifting plant with macerator
<b>32</b>	Discharge connection size (DN 25/32)
<b>-0,4</b>	Motor power rating [kW]
<b>EM</b>	Single phase 1 ~ 230 V, 50 Hz

### Application

Fully self contained collecting and pumping unit for the **limited use** (by direct connection to a toilet pan outlet) with macerator to displace soil drainage from a single WC pan and additionally waste water from a wash basin, a shower, or a bidet in such cases where it cannot be disposed into the sewer mains by natural flow or the pumping of waste water from below the backflow level. It is imperative to comply with the requirements of DIN EN 12050 (draft) and Din 1986 or any other applicable local regulations.

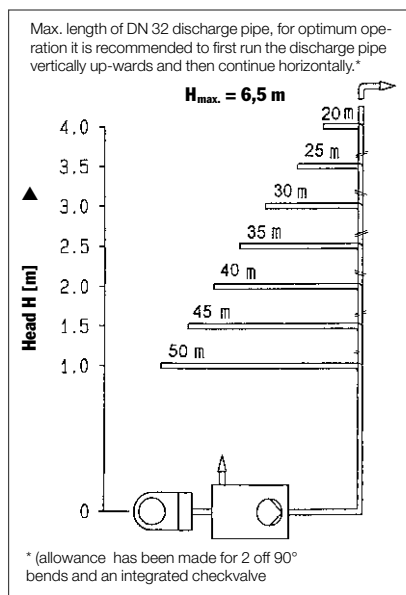

When connecting to a greater number of sanitary fixtures than listed above we recommend the use of series Wilo-Opti-Box TMP or Wilo-Opti-Master-Box FH/D-FH.

### Technical Data

Performance	
Mains power	1~230 V, 50 Hz
Rated power	0.45 kW
F.L.C. I	2.1 A
Operating mode	Intermittent operation S3
	28%/36 secs, to DIN, VDE 0530 part 1
Dimensions W/H/D	500/300/265 mm
Power cable length	1.2 m
Net volume	12 litres
Max. head	5.7 m
Max. flowrate	4 m³/h
Fluid temp.	35° C
<b>Degree of protection</b>	IP 44 (Optionally submersed)*
<b>Weight</b>	7.8 kg
Material	STYRON 457
Colour	RAL 9003 full gloss white
<b>Certification No.*</b>	Z-53.3-355

\* In such case it is necessary to extend the vent from the level switch above flood level

### Article No. 002011011

### Connections

- Inlet**
- DN 100 (Direct connection with sealing sleeve)
  - 2 off blanked-off inlets DN 40 and one checkvalve

- Discharge**
- DN 25/32 discharge connection with angle hose fittings including check valve

**Vent:**  
Optionally integrated active carbon filter with overflow protection or separate vent pipe above roof level connected by means of self-sealing sleeve (DN 25 OD pipe).

### Plant Description

Automatically operating Mini sewage lifting unit with macerator, all necessary switch and control gear, inbuilt swing check valve, active-carbon filter, flexible discharge socket, connections facilities for one WC, two additional waste fixtures and one vent pipe.

The KH 32 Mini lifting unit is directly connected to P-trap pedestal pan.

Pipe connections from additional sanitary fixtures and the discharge pipe are at the rear side of unit and can be optionally connected to from the right- or left-hand side. The unit is vented either directly into the room via an active carbon filter or above roof level by means of a vent pipe.

### Benefits for the User

- Up-to-date design – fits harmoniously and unobtrusively into your bathroom concept
- Self-sealing direct WC connection
- Modern housing construction, concealed pipework
- All additional connections are installer-friendly at the rear of the unit
- The easiest of maintenance – sieve basket and macerator are easily accessible
- Low noise operation due to submersible pump
- Ideally suited for updating and refurbishing

### Wilo-Opti-Box KH

#### Unit Diagram

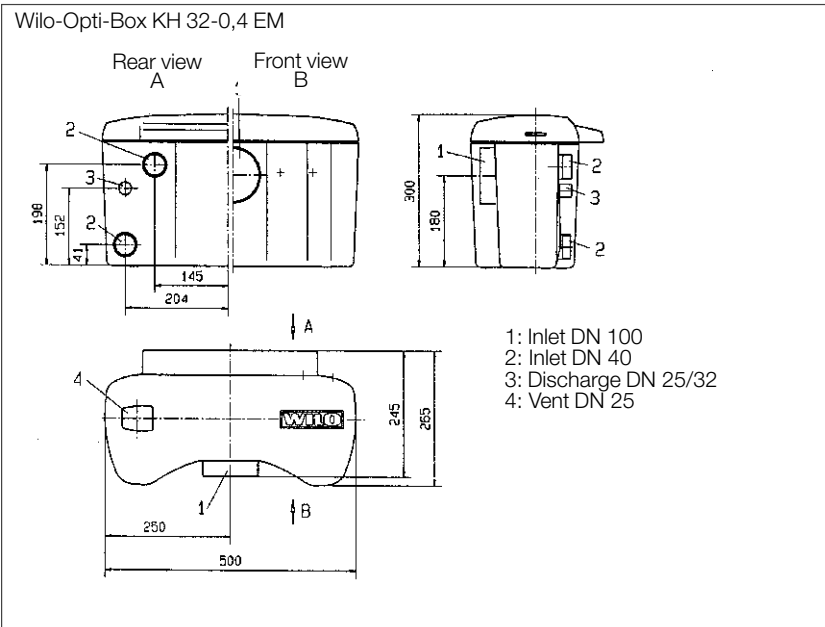

#### Typical Installation Scheme

